

# CASCO®



## PF 112

USER INSTRUCTIONS



### Directions for use

Thank you for having selected a CASCO helmet. Safety helmets belong to personal protective equipment and help to prevent or, at least, to diminish head injuries. Please take the time to read the following directions for the adjustment of your helmet. It will be for the sake of your safety and for optimum wearing convenience.

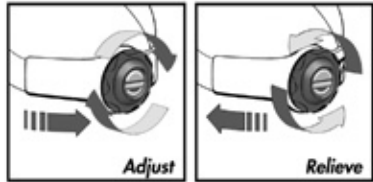

### Adjusting your head size using the Disk-Fit™ turn knob fastener

To adjust the head ring to your head size you can use the turn knob fastener provided in the neck area. Turn the knob fully in anticlockwise sense to open the head ring. Put your helmet on and turn the knob clockwise to tighten the head ring until you obtain a convenient but snug fit of your helmet.

### Adjusting the neck strapping

This adjustment needs to be made only once before you wear your helmet for the first time. Use the black metal buckle to adjust the length of the strap so that it snugly fits the side of your neck and the chin strap does not cover your ear. In the rear of the helmet, the strap is deflected. If you pull the left or right part of the strap you can equally adjust its length on either side.

### Adjusting the chin strapping

On one side, the chin strap has an open and a closed buckle, either of which you can use as desired. In case of danger, a strong jerk exercised on the open buckle (panic lock) will open the strap. Close the strap with the pushbutton safety buckle and adjust its length with the free end. Stow the free end with the snap fastener.

#### IMPORTANT:

Protection will only be guaranteed if your helmet fits to an optimum, the head ring is adapted to your head size and the chin strap is closed. Never wear your helmet when it is not completely assembled.



Click in



Release

### Visor fitting

Your PF 112 helmet has a multi-function mount for visor quick fitting. To fit the visor click it into the multi-function mount. To remove it press the two lock buttons.



### Lampfitting

Optionally, you can fit a lamp bracket to each of the multi-function adapters (right/left).



Loosening the central screw



Pulling off the visor mechanism



Threading in the lamp bracket axial screw

### Helmet modifications

**IMPORTANT:** The normal design of your helmet meets the applicable standards and, therefore, must not be modified or equipped with components from other manufacturers. Do not use any spare parts and accessories other than those offered by us. Never wear your helmet when it is not completely assembled.

### Cleaning & maintenance

To clean the helmet shell and its interior only use lukewarm soap water. You can also use disinfectants to treat the interior of the helmet. Do not use any solvents. The appropriate cleaning, maintenance and treatment of your safety helmet is a precondition for its unobjectionable functioning.

### Usable life

The shell of your CASCO PF 112 helmet is made of highly heat-resistant glass fibre compound material and has an outstanding ageing stability. However, the usable life of such helmets is mainly restricted by mechanical damage and should not exceed eight (8) years. Please check the shell and the interior fittings of your helmet at regular intervals. If you detect any visible signs of damage please replace your helmet. Do not wear your helmet again after it has suffered a strong impact, even if it does not show any externally visible damage.

### Storage

Keep your safety helmet and its visor at a cool, dry and light-protected place. Avoid direct influence of sunlight to prevent any possible damage by UV radiation, for example, of the photo-luminescent paintcoating.

### Warranty

Proper usage provided, we shall warrant your helmet for 24 months to be free of material or manufacturing defects. CASCO shall effect repair, replacement or crediting at their own discretion. Returning to us your helmet franco domicile shall be a precondition for any warranty claims. The helmet must not deviate from its original state and/or be damaged by improper usage.

### Approval

Your helmet has been approved in accordance with the following standards: EN 443 for fire helmets. This helmet meets the safety requirements of DIN 14940 and of Technical Directive No. 17 of the Ministry of the Interior of Lower Saxony.

### Changing parts

All components of your helmet have been designed so that they can be easily changed without any specific tools. By a snap fastener system, you can remove the sweatband for easy cleaning or replacement. You can also change the entire suspension assembly by loosening the fastening screws and pulling the suspension out of its lateral holders.

To remove/refit the strapping, the neck protector attachment and the inner shell unscrew the two multi-function mounts and the rear strap deflector.

### IMPORTANT NOTES FOR YOUR SAFETY

The protection a helmet offers depends on the circumstances under which an accident happens, and wearing a helmet is not always a remedy for preventing fatal consequences or invalidity for a longer time. Always wear your helmet at the correct position and remember that no helmet can protect your neck or exposed areas of your head. This helmet has been exclusively approved for use in fire fighting as well as for rescue operations and disaster procedures. It has neither been approved for any kind of sports nor for biking.

## Explanation of the symbols for optional requirements:

**14**

«««««»»»»»  
Radiant heat classification:  
14 kW/m<sup>2</sup>

\*\*\*

Low-temperature  
classification:  
-40°C

Classification of electrical properties:

**E2** • Damp-proof  
according to 6.8.2  
**E3** • Surface-insulated  
according to 6.8.3

### Spare parts & accessories

All replacement and/or spare parts are exclusively intended for use in connection with the CASCO PF 112 helmet.

|  |                      |
|--|----------------------|
| - Inner shell / PU-liner   | <b>04.08.112.00</b>  |
| - Visor, complete incl. multifunctional adapter & visor frame,<br>2mm Polycarbonate, standard clear                      | <b>04.08.2043.01</b> |
| - Visor, complete incl. multifunctional adapter & visor frame,<br>2mm Polycarbonate, clear both sides scratchproof       | <b>04.08.2043.00</b> |
| - Multifunction adapter separatly (1 pc) as lightholder<br>w/o visor mechanic  | <b>04.08.5034.03</b> |
| - Anti-fog and antistatic gel  | <b>04.08.6010.00</b> |
| - Flashlight holder, for mounting on to the multifunctional<br>adapters (right/left)                                     | <b>04.08.5034.02</b> |
| - Flashlight (Xenonlight)  | <b>04.08.5035.01</b> |
| - Harness complete incl. headband with Disk-Fit-Adjustment, suspension<br>bands and velours padding                      | <b>05.08.2014.04</b> |
| - Chin-/neckstrapping complete incl. multifunction plug, rear holder,<br>3 Inbus-screws, plastic buckle, without leather | <b>05.08.2014.05</b> |
| - Neck protection holder incl. screws  | <b>04.08.2031.02</b> |
| - Neck protector leathern  | <b>04.08.2031.01</b> |
| - Helmet PF 112 VIK  | <b>05.08.112.VIK</b> |

The present documentation provides information on the state of the art at the time of printing.  
We reserve the right to introduce technical advancements and modifications as a result of  
changing standards. Errors excepted.

As at February 2007

CASCO Schutzhelme GmbH  
Gewerbering Süd 11  
D-01900 Brettnig

casco-schutzhelme@t-online.de  
www.casco-helme.de

fon: 0049 35955 839-0  
fax: 0049 35955 839-99



**CASCO**<sup>®</sup>

ULTIMATE HEADWEAR